

Features

- Fast switching speed
- High conductance

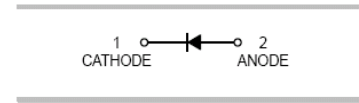

Mechanical Data

- Case: SOD-323
- Molding Compound: UL Flammability Classification Rating 94V-0
- Terminals: Matte tin-plated leads; solderability-per MIL-STD-202, Method 208

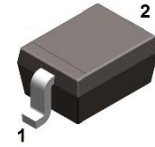

SOD-323

Ordering Information

Part Number	Package	Shipping Quantity	Marking Code
BAS16H	SOD-323	3000 pcs / Tape & Reel	A6

Maximum Ratings ($T_A = 25^\circ\text{C}$ unless otherwise specified)

Parameter	Symbol	Value	Unit
DC Blocking Voltage	V_R	75	V
Forward Continuous Current	I_F	200	mA
Non-Repetitive Peak Forward Surge Current, $t = 1\text{ms}$	I_{FSM}	1	A
Non-Repetitive Peak Forward Surge Current, $t = 1\text{s}$		0.5	A

Thermal Characteristics

Parameter	Symbol	Value	Unit
Power Dissipation	P_D	200	mW
Thermal Resistance (Junction-to-Ambient) ^{*1}	$R_{\theta JA}$	410	$^\circ\text{C/W}$
Thermal Resistance (Junction-to-Case) ^{*1}	$R_{\theta JC}$	220	$^\circ\text{C/W}$
Thermal Resistance (Junction-to-Lead) ^{*1}	$R_{\theta JL}$	210	$^\circ\text{C/W}$
Operating Junction Temperature Range	T_J	-55 ~ +150	$^\circ\text{C}$
Storage Temperature Range	T_{STG}	-55 ~ +150	$^\circ\text{C}$

Note 1: The data tested by surface mounted on a 15mm * 15mm * 1mm FR4-epoxy P.C.B

Electrical Characteristics (@ $T_A = 25^\circ\text{C}$ unless otherwise specified)

Parameter	Symbol	Test Condition	Min.		Max.	Unit
Reverse Breakdown Voltage	$V_{(BR)R}$	$I_R = 100\mu\text{A}$	75	-	-	V
Forward Voltage	V_F	$I_F = 1\text{mA}$	-	-	0.715	V
		$I_F = 10\text{mA}$	-	-	0.855	V
		$I_F = 50\text{mA}$	-	-	1.000	V
		$I_F = 150\text{mA}$	-	-	1.250	V
Maximum Peak Reverse Current	I_R	$V_R = 75\text{V}$	-	-	1	μA
		$V_R = 25\text{V}, T_J = 125^\circ\text{C}$	-	-	30	μA
		$V_R = 75\text{V}, T_J = 150^\circ\text{C}$	-	-	50	μA
Total Capacitance	C_J	$V_R = 0\text{V}, f = 1.0\text{MHz}$	-	-	2	pF
Reverse Recovery Time	t_{rr}	$I_F = I_R = 10\text{mA}$ $I_{rr} = 0.1 \times I_R, R_L = 100\Omega$	-	-	5	ns

Ratings and Characteristics Curves (@ $T_A = 25^\circ\text{C}$ unless otherwise specified)

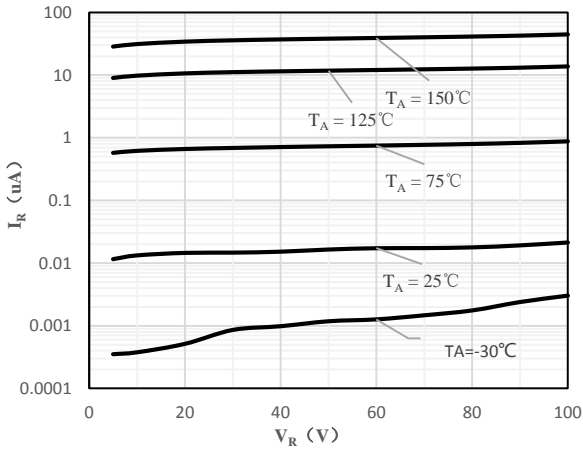

Fig 1 Typical Reverse Characteristic

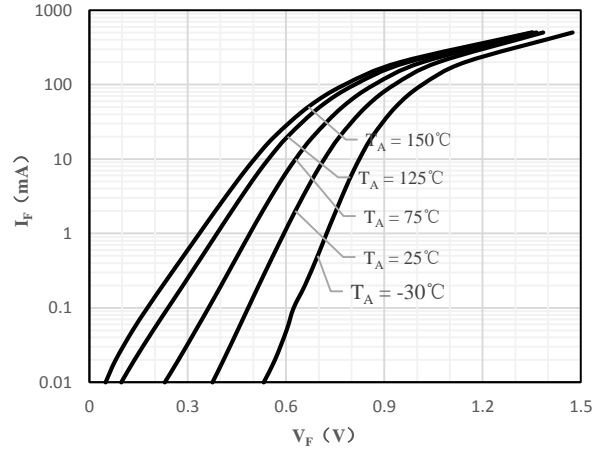

Fig 2 Typical Forward Characteristics

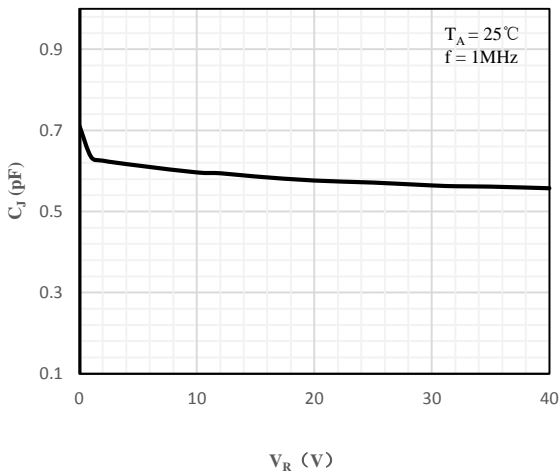

Fig 3 Capacitance vs. Reverse Voltage

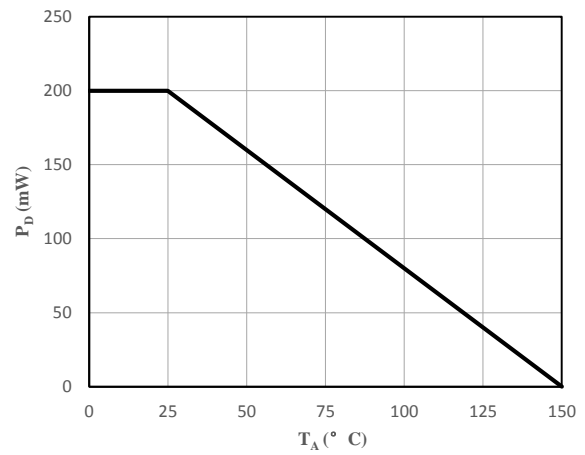
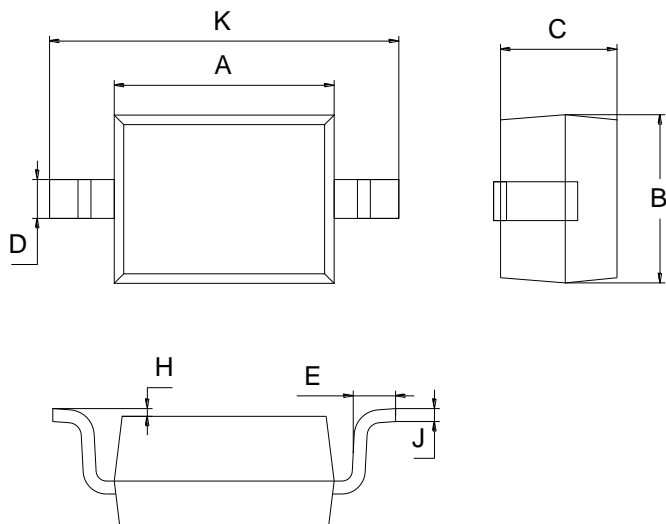

Fig 4 Power Derating Curve

Package Outline Dimensions (Unit: mm)



SOD-323		
Dimension	Min.	Max.
A	1.60	1.80
B	1.20	1.40
C	0.80	0.90
D	0.25	0.35
E	0.22	0.42
H	0.02	0.10
J	0.05	0.15
K	2.55	2.75

Mounting Pad Layout (Unit: mm)

SOD-323

