

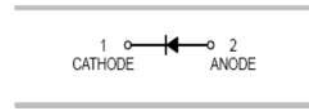

Features

- For super-high speed switching circuit.
- For small current rectification.
- Allowing to rectify under (IF(AV)=200mA) Condition.
- Allowing high-density mounting.



Typical Applications

- Schottky epitaxial planar



Mechanical Data

- Case: SOD-323
- Molding compound, UL flammability classification rating 94V-0.
- Terminals: Tin plated leads, solderable per MIL-STD-202, Method 208.

SOD-323

Ordering Information

Part Number	Package	Shipping	Marking Code
MA729□	SOD-323	3000/Tape Reel	2B

□: none is for Lead Free package;
 “G” is for Halogen Free package.

Maximum Ratings (@TA=25°C unless otherwise specified)

Parameter	Symbol	Value	Units
DC Reverse Voltage	V_R	30	V
Repetitive Peak Reverse Voltage	V_{RRM}	30	V
Peak Forward Current	I_{FM}	300	mA
Average Forward Current	$I_{F(AV)}$	200	mA
Non-repetitive Peak Forward Surge Current	I_{FSM}	1000	mA

Thermal Characteristics

Parameter	Symbol	Value	Units
Power Dissipation	P_D	200	mW
Typical Thermal Resistance per leg	$R_{\theta JA}^*$	500	°C/W
Operating Junction Temperature Range	T_J	125	°C
Storage Temperature Range	T_{STG}	-40 to +150	°C

* Part mounted on FR-4 board with recommended pad layout



Electrical Characteristics (@ $T_A=25^\circ\text{C}$ unless otherwise specified)

Parameter	Symbol	Test conditions	Min.	Typ.	Max.	Units
Reverse Breakdown Voltage	$V_{(BR)R}$	$I_R=100\mu\text{A}$	30	-	-	V
Forward voltage	V_F^*	$I_F=200\text{mA}$	-	-	0.55	V
Reverse leakage current	I_R^{**}	$V_R=30\text{V}$	-	-	50	μA
Reverse recovery time	t_{rr}	$I_F=I_R=100\text{mA}$, $I_{rr}=10\text{mA}, R_L=100\Omega$	-	3.0	-	ns
Total capacitance	C_T	$V_R=0\text{V}, f=1.0\text{MHz}$	-	30	-	pF

*Pulse width $\leq 380\ \mu\text{s}$, Duty cycle $< 2\%$
 **pulse test, $t_p \leq 5\text{ms}$

Ratings and Characteristic Curves ($T_A=25^\circ\text{C}$ unless otherwise noted)

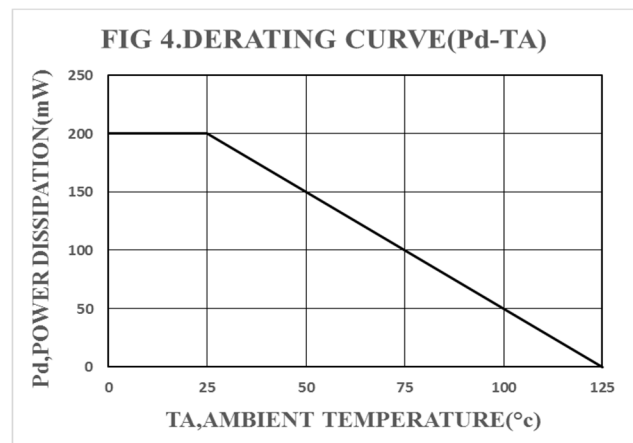
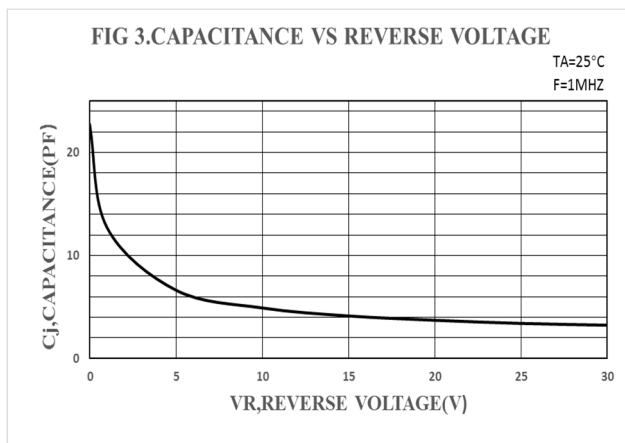
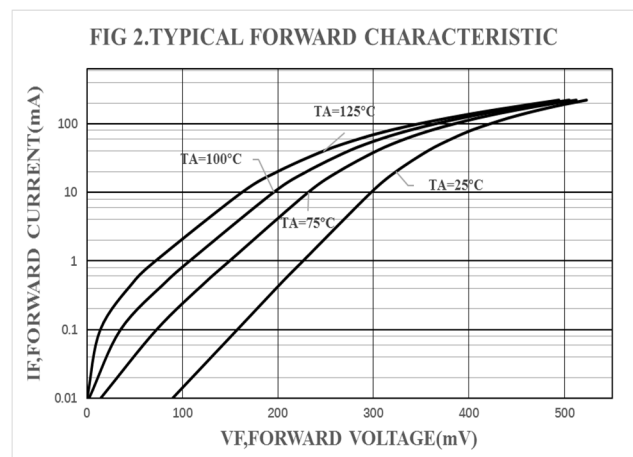
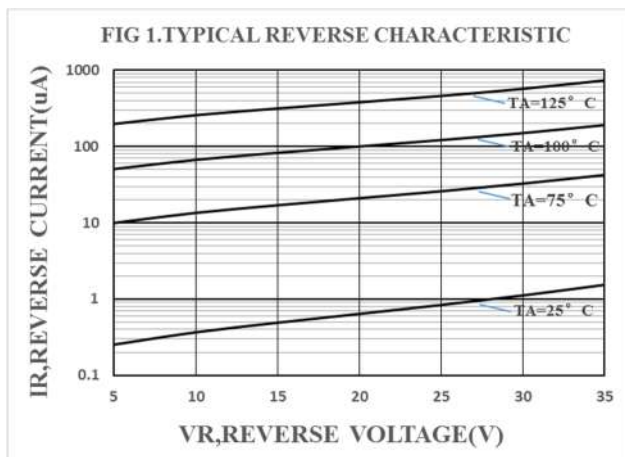



Package Outline Dimensions(unit:mm)

SOD-323

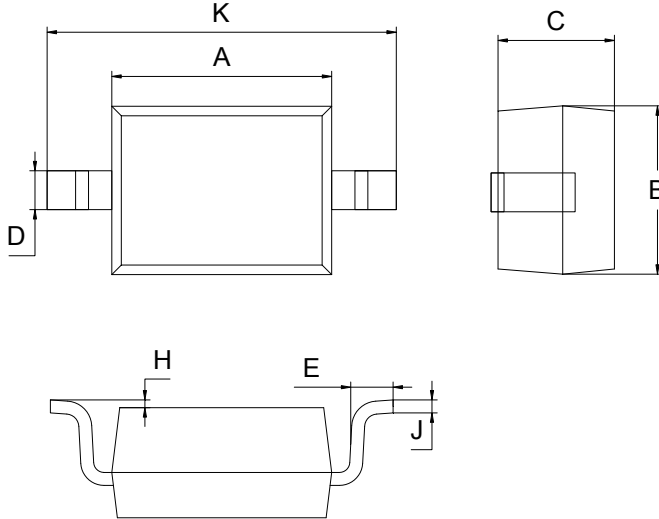

SOD-323		
Dim	Min	Max
A	1.60	1.80
B	1.20	1.40
C	0.80	0.90
D	0.25	0.35
E	0.22	0.42
H	0.02	0.10
J	0.05	0.15
K	2.55	2.75

Mounting Pad Layout(unit:mm)

SOD-323

