

Features

- High reliability
- Silicon epitaxial planar

Mechanical Data

- Case: SOT-353
- Molding Compound: UL Flammability Classification Rating 94V-0
- Terminals: Matte tin-plated leads; solderability-per MIL-STD-202, Method 208

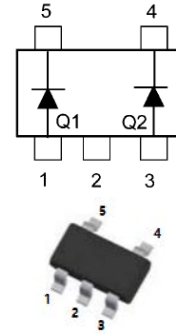

SOT-353

Ordering Information

Part Number	Package	Shipping Quantity	Marking Code
RB480KS	SOT-353	3000pcs / Tape & Reel	3T

Maximum Ratings (@ T_A = 25°C unless otherwise specified)

Peak Repetitive Reverse Voltage	V _{RRM}	45	V
DC Reverse Voltage	V _R	40	V
Maximum Average Forward Output Current	I _{F(AV)}	0.1	A
Peak Forward Surge Current (8.3ms single half sine-wave)	I _{FSM}	1	A

Thermal Characteristics

Parameter	Symbol	Value	Unit
Operating Junction Temperature	T _J	125	°C
Storage Temperature Range	T _{STG}	-40 ~ +125	°C

Electrical Characteristics (@ T_A = 25°C unless otherwise specified)

Parameter	Symbol	Test Condition	Min.	Typ.	Max.	Unit
Forward Voltage	V _F	I _F = 10mA	-	-	0.45	V
		I _F = 100mA	-	-	0.60	V
Maximum Peak Reverse Current	I _R	V _R = 10V	-	-	1	μA
		V _R = 40V	-	-	5	μA
Capacitance Between Terminals	C _J	V _R = 0V, f = 1MHz	-	-	25	pF

Ratings and Characteristic Curves (@ $T_A = 25^\circ\text{C}$ unless otherwise specified)

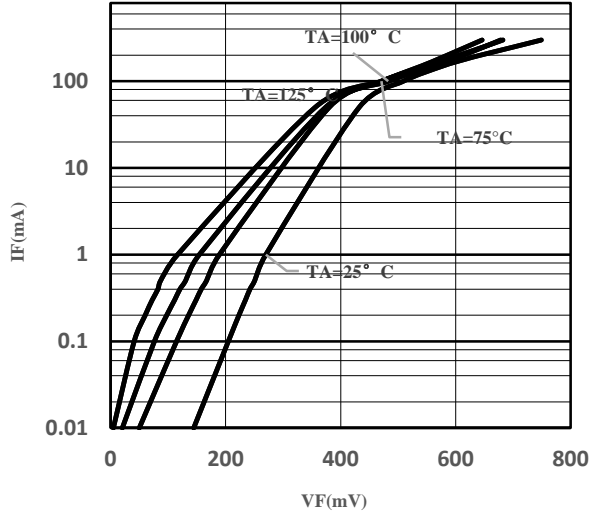

Fig 1 Forward Characteristics

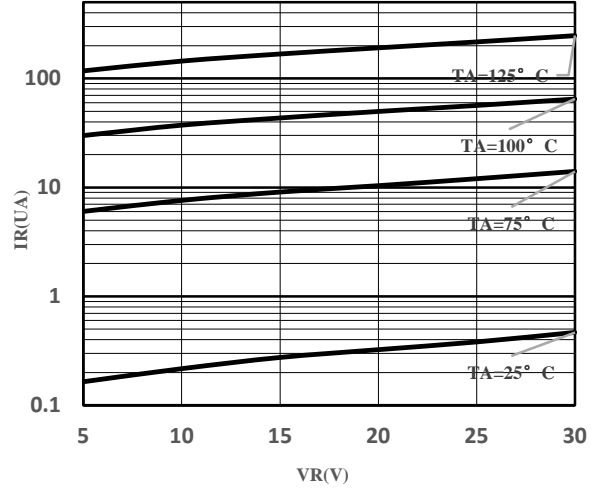
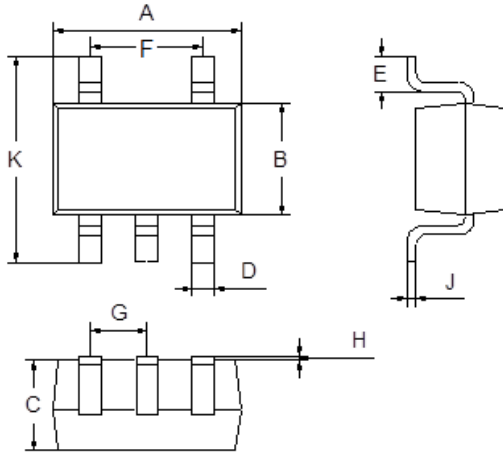

Fig 2 Typical Reverse Characteristics



Package Outline Dimensions (Unit: mm)



SOT-353		
Dimension	Min.	Max.
A	2.00	2.20
B	1.15	1.35
C	0.85	1.05
D	0.15	0.35
E	0.25	0.40
F	1.20	1.40
G	0.60	0.70
H	0.02	0.10
J	0.05	0.15
K	2.20	2.40

Mounting Pad Layout (Unit: mm)

SOT-353

