

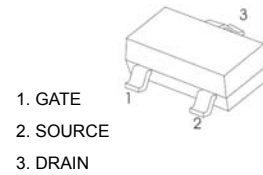

FEATURE

- High power and current handing capability
- Lead free product is acquired
- Surface mount package

SOT-23



MARKING: 2308

Equivalent Circuit

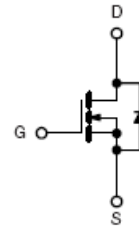

Maximum ratings ($T_a=25^{\circ}\text{C}$ unless otherwise noted)

Parameter	Symbol	Value	Unit
Drain-Source Voltage	V_{DS}	60	V
Gate-Source Voltage	V_{GS}	± 20	V
Continuous Drain Current	I_D	3	A
Pulsed Drain Current (note 1)	I_{DM}	10	A
Power Dissipation	P_D	0.35	W
Thermal Resistance from Junction to Ambient (note 2)	$R_{\theta JA}$	357	$^{\circ}\text{C}/\text{W}$
Junction Temperature	T_J	150	$^{\circ}\text{C}$
Storage Temperature	T_{STG}	-55~+150	$^{\circ}\text{C}$



Electrical characteristics (T_a=25°C unless otherwise noted)

Parameter	Symbol	Test Condition	Min	Typ	Max	Unit
STATIC CHARACTERISTICS						
Drain-source breakdown voltage	V _{(BR)DSS}	V _{GS} = 0V, I _D = 250μA	60			V
Zero gate voltage drain current	I _{DSS}	V _{DS} = 60V, V _{GS} = 0V			1	μA
Gate-body leakage current	I _{GSS}	V _{GS} = ±20V, V _{DS} = 0V			±100	nA
Gate threshold voltage (note 3)	V _{GS(th)}	V _{DS} = V _{GS} , I _D = 250μA	0.5		2	V
Drain-source on-resistance (note 3)	R _{DS(on)}	V _{GS} = 10V, I _D = 3A			105	mΩ
		V _{GS} = 4.5V, I _D = 3A			125	mΩ
Forward tranconductance (note 3)	g _{FS}	V _{DS} = 15V, I _D = 2A	1.4			S
Diode forward voltage (note 3)	V _{SD}	I _S = 3A, V _{GS} = 0V			1.2	V
DYNAMIC CHARACTERISTICS (note 4)						
Input Capacitance	C _{iss}	V _{DS} = 30V, V _{GS} = 0V, f = 1MHz		247		pF
Output Capacitance	C _{oss}			34		pF
Reverse Transfer Capacitance	C _{rss}			19.5		pF
SWITCHING CHARACTERISTICS (note 4)						
Turn-on delay time	t _{d(on)}	V _{GS} = 10V, V _{DD} = 30V, I _D = 1.5A, R _{GEN} = 1Ω		6		ns
Turn-on rise time	t _r			15		ns
Turn-off delay time	t _{d(off)}			15		ns
Turn-off fall time	t _f			10		ns
Total Gate Charge	Q _g	V _{DS} = 30V, V _{GS} = 4.5V, I _D = 3A		6		nC
Gate-Source Charge	Q _{gs}			1		nC
Gate-Drain Charge	Q _{gd}			1.3		nC

Notes :

1. Repetitive rating : Pulse width limited by junction temperature.
2. Surface mounted on FR4 board , t_s ≤ 10s.
3. Pulse Test : Pulse Width ≤ 300μs, Duty Cycle ≤ 0.5%.
4. Guaranteed by design, not subject to producing.



Typical Characteristics

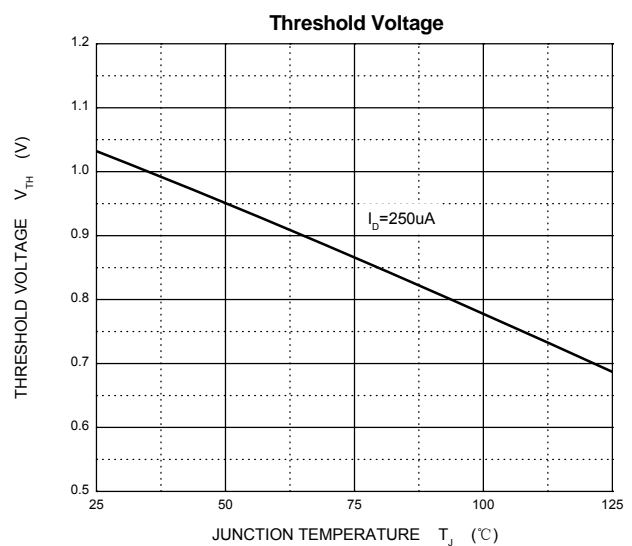
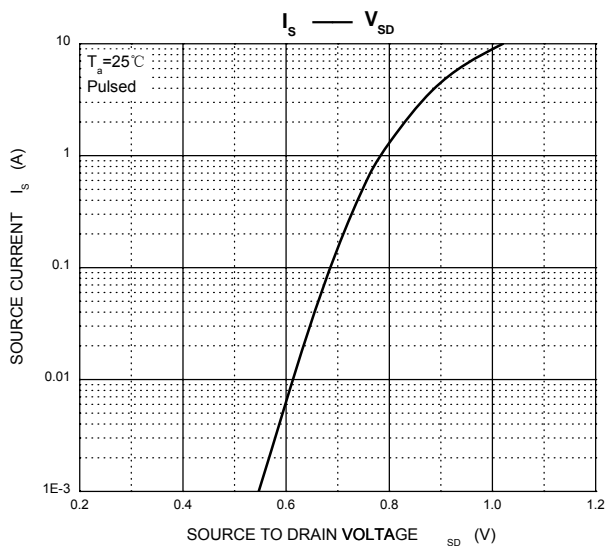
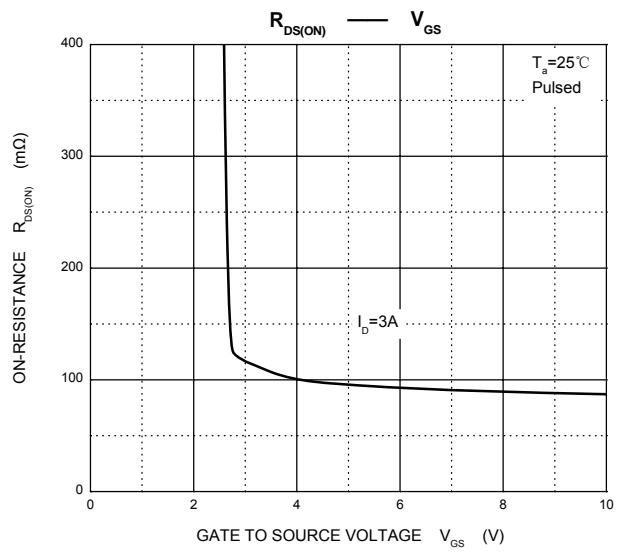
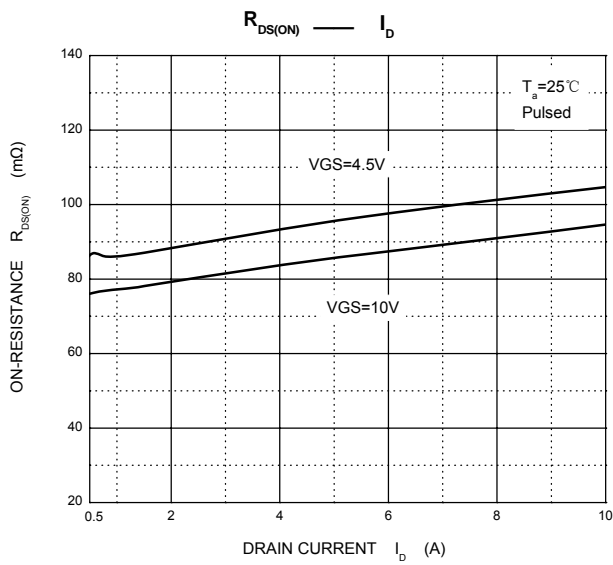
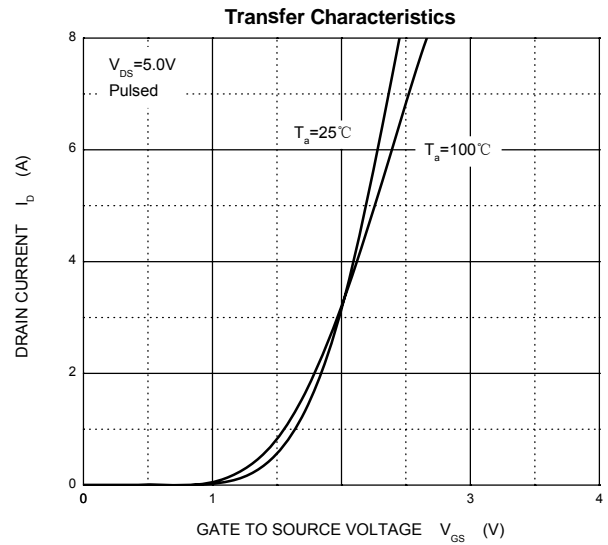
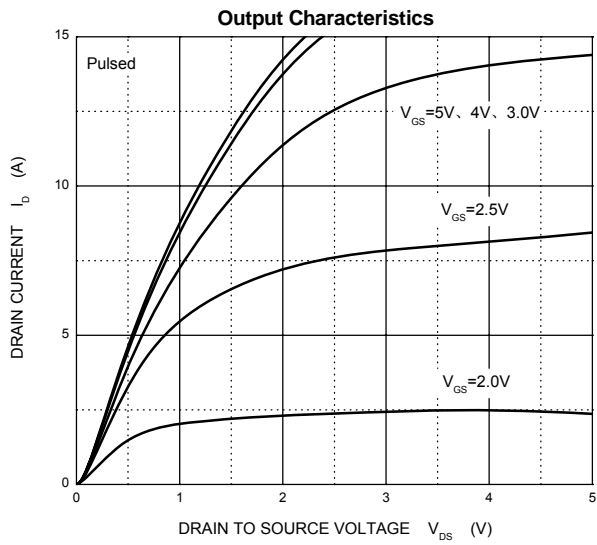



PACKAGE OUTLINE

Plastic surface mounted package; 3 leads

SOT-23

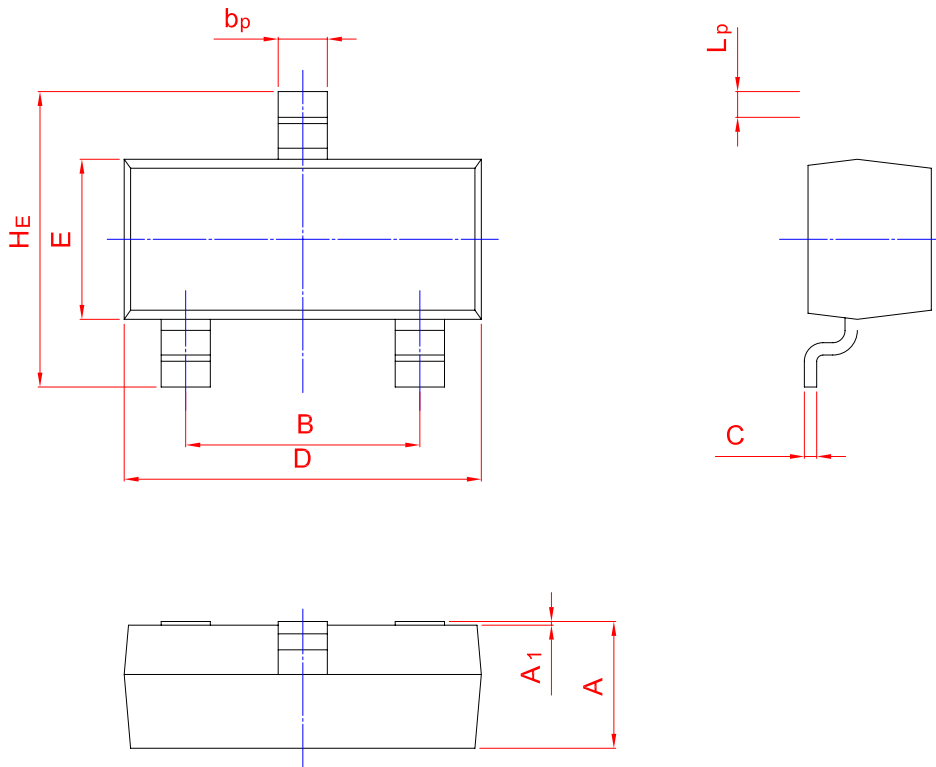
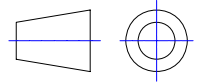

UNIT	A	B	b_p	C	D	E	H_E	A_1	L_p
mm	1.40	2.04	0.50	0.19	3.10	1.65	3.00	0.100	0.50
	0.95	1.78	0.35	0.08	2.70	1.20	2.20	0.013	0.20

Package	Reel	Reel Size	Box	Box Size(mm)	Carton	Carton Size(mm)
SOT-23	3000pcs	7inch	45,000pcs	203×203×195	180,000pcs	438×438×220