



### Application

- Audio Frequency Power Amplifier
- Low Speed Switching

### Features

- Low saturation voltage  $V_{CE(sat)}$ .
- Complement to 2SB772

TO-92

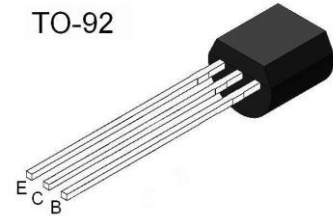

### Absolute Maximum Ratings (Ta=25°C)

Parameter	Symbol	Value	Unit
Collector-Base Voltage	$BV_{CBO}$	40	V
Collector-Emitter Voltage	$BV_{CEO}$	30	V
Emitter-Base Voltage	$BV_{EBO}$	5	V
Collector Current	$I_C$	1	A
Collector Power Dissipation	$P_C$	800	mW
Junction Temperature	$T_j$	150	°C
Storage Temperature	$T_{stg}$	-55~+150	°C

### Electrical Characteristics (Ta=25°C)

Parameter	Symbol	Conditions	Min	Typ	Max	Unit
Collector-baser breakdown voltage	$BV_{CBO}$	$I_C = 100\mu A, I_E = 0$	40			
Collector-emitter breakdown voltage	$BV_{CEO}$	$I_C = 1mA, I_B = 0$	30			V
Emitter-base breakdown voltage	$BV_{EBO}$	$I_E = 100\mu A, I_C = 0$	5			V
Collector cut-off current	$I_{CBO}$	$V_{CB} = 30V, I_E = 0$			0.1	$\mu A$
Emitter cut-off current	$I_{EBO}$	$V_{EB} = 5V, I_C = 0$			0.1	$\mu A$
DC current gain*	$h_{FE1}$	$V_{CE} = 1V, I_C = 0.1A$	60		400	
	$h_{FE2}$	$V_{CE} = 1V, I_C = 0.5A$	20			
Collector-emitter saturation voltage*	$V_{CE(sat)}$	$I_C = 1A, I_B = 0.1A$			0.5	V
Base-emitter saturation voltage*	$V_{BE(sat)}$	$I_C = 1A, I_B = 0.1A$			1.2	V
Transition frequency	$f_T$	$V_{CE} = 10V, I_B = 0.1A$		90		MHz
Output Capacitance	$C_{ob}$	$V_{CE} = 10V, I_E = 0, f = 1MHz$		45		pF

\* Pulse Test:  $PW \leq 350\mu s$ , Duty Cycle  $\leq 2\%$  Pulsed

### $h_{FE1}$ Classification

Classification	R	Q	P	E
Range	60~120	100~200	160~320	200~400

### Typical Characteristics

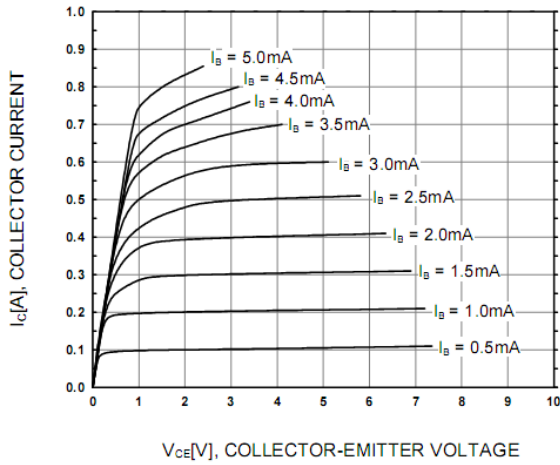

Figure.1 Static characteristics

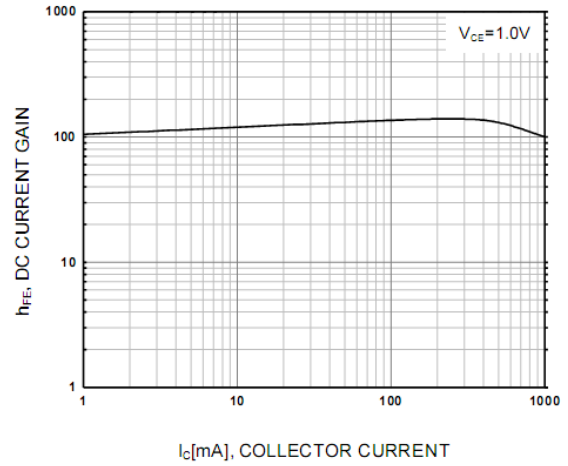

Figure.2 DC Current Gain

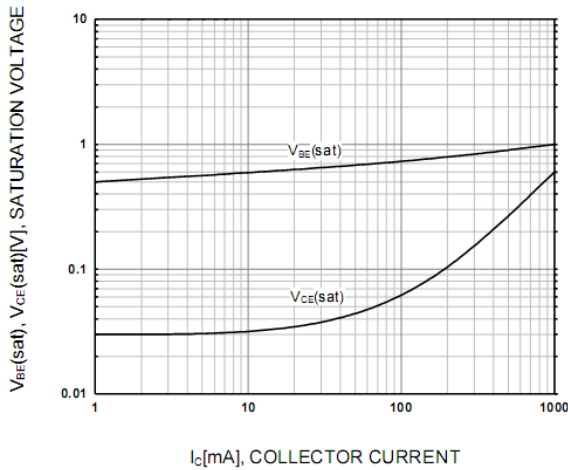

Figure.3 Saturation voltage

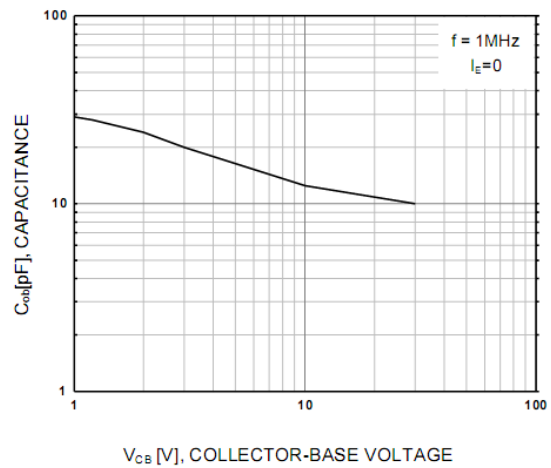

Figure 4. Collector Output Capacitance

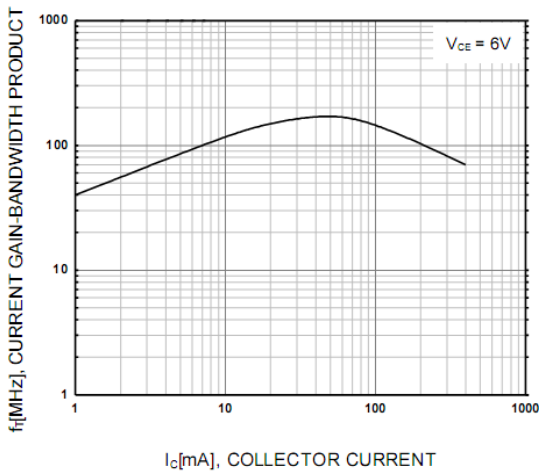

Figure.5 Current Gain-Bandwidth Product

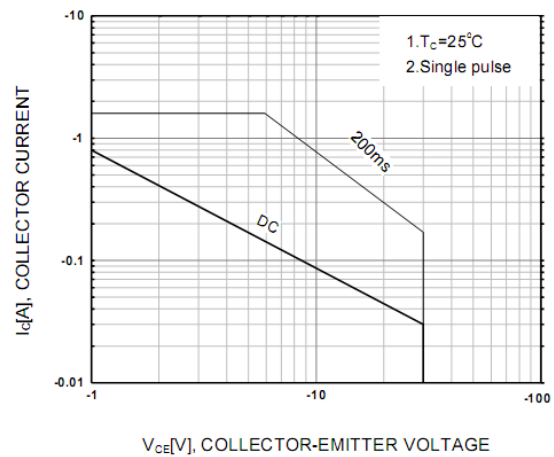
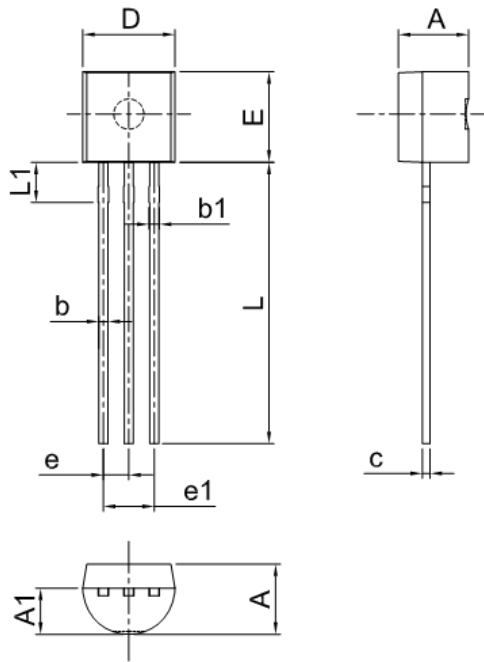

Figure.6 Safe Operation Area



### Package Dimensions



Dim	Millimeter		Inches	
	Min.	Max.	Min.	Max.
A	3.30	3.70	0.130	0.146
A1	2.30	2.70	0.091	0.106
b	0.40	0.50	0.016	0.020
b1	0.50	0.70	0.020	0.028
c	0.35	0.45	0.014	0.018
D	4.45	4.70	0.175	0.185
E	4.40	4.65	0.173	0.183
e	1.17	1.37	0.046	0.054
e1	2.34	2.64	0.092	0.104
L	13.50	14.50	0.531	0.571
L1	1.80	2.20	0.071	0.087

Package	Packing	Quantity	Box	Box Size(mm)	Carton	Carton Size(mm)
TO-92	Bulk	1000pcs/BP	10,000pcs	245×170×100	100,000pcs	525×375×270
TO-92	Tape	2000pcs/TP	2000pcs	333×162×43	20,000pcs	350×340×250