

## FEATURES

- Rating to 1000V PRV
- Surge overload rating to 135 Amperes peak
- Ideal for printed circuit board
- Reliable low cost construction utilizing molded plastic technique results in inexpensive product
- Lead solderable per MIL-STD-202 method 208

## MECHANICAL DATA

- Polarity: Symbols molded on body
- Weight: 0.16 ounces, 4.45 grams
- Mounting position: Any

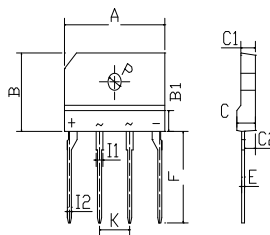

KBJ4		
Dim	Min	Max
A	24.80	25.20
B	14.80	15.20
B1	3.80	4.20
C	4.50	4.80
C1	3.50	3.80
C2	2.60	3.00
E	0.60	0.80
F	17.15	17.75
I1	1.55	1.85
I2	0.85	1.15
K	7.20	7.80
P	Ø3.25Typical	
All Dimensions in mm		

## Maximum Ratings (@TA = 25°C unless otherwise specified)

Characteristic	Symbol	KBJ4A	KBJ4B	KBJ4D	KBJ4G	KBJ4J	KBJ4K	KBJ4M	UNITS
Maximum recurrent peak reverse voltage	$V_{RRM}$	50	100	200	400	600	800	1000	V
Maximum RMS voltage	$V_{RMS}$	35	70	140	280	420	560	700	V
Maximum DC blocking voltage	$V_{DC}$	50	100	200	400	600	800	1000	V
Maximum average forward Output current @TA=100°C	$I_{F(AV)}$	4.0							A
Peak forward surge current 8.3ms single half-sine-wave superimposed on rated load	$I_{FSM}$	135.0							A
I <sup>2</sup> t Rating for fusing @Tj=25°C	I <sup>2</sup> t	75							A <sup>2</sup> S

## Thermal Characteristics

Characteristic	Symbol	KBJ4A	KBJ4B	KBJ4D	KBJ4G	KBJ4J	KBJ4K	KBJ4M	UNITS
Typical junction capacitance per element	$C_J$	45							pF
Typical thermal resistance	$R_{\theta JA}$ $R_{\theta JC}$	26 4.0							°C/W
Operating junction temperature range	$T_J$	- 55 ---- + 150							°C
Storage temperature range	$T_{STG}$	- 55 ---- + 150							°C

## Electrical Characteristics (@TA = 25°C unless otherwise specified)

Characteristic	Symbol	KBJ4A	KBJ4B	KBJ4D	KBJ4G	KBJ4J	KBJ4K	KBJ4M	UNITS
Maximum instantaneous forward voltage @2.0A @4.0A	$V_F$	1.0 1.1							V
Maximum reverse current @TA=25 °C at rated DC blocking voltage @TA=100°C	$I_R$	5.0 0.5							μA mA

NOTES:1. Measured at 1.0MHZ and applied reverse voltage of 4.0V DC

2. Dev ice mounted on 300mm X 300mm X 1.6mm cu Plate heatsink.

**Fig.1- Surge Current Derating Curve**

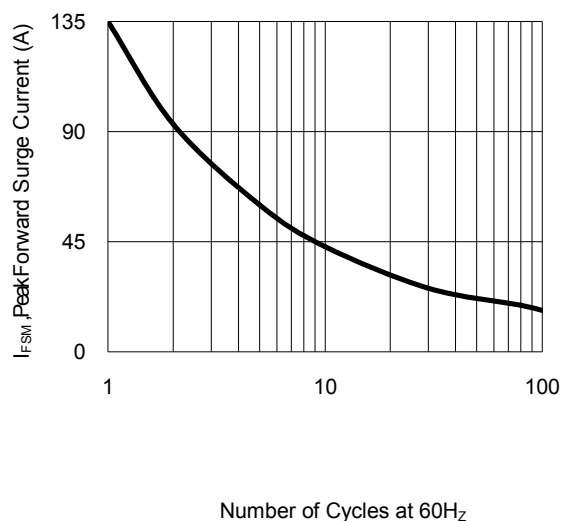

**FIG.2 – FORWARD DERATING CURVE**

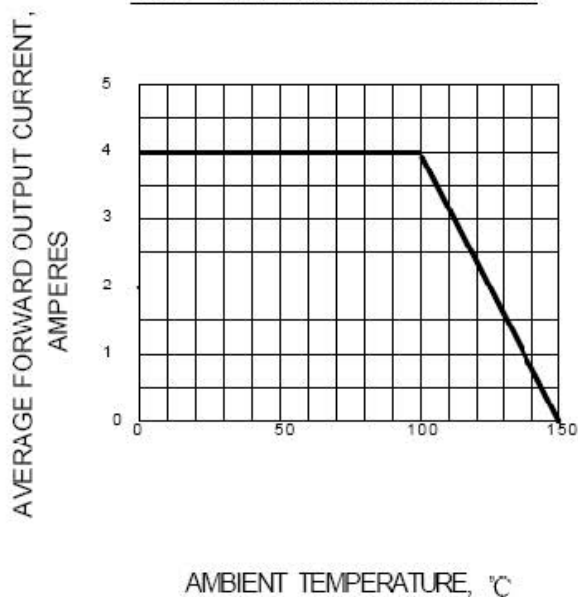

**FIG.3 – TYPICAL FORWARD CHARACTERISTIC**

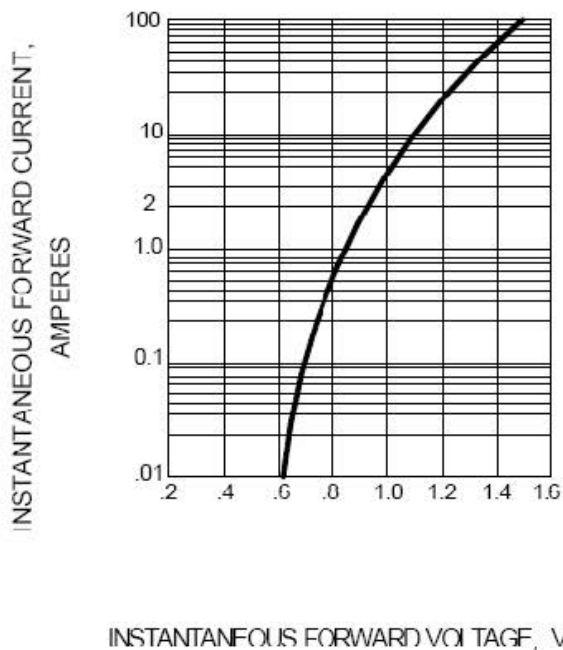

**FIG.4 – TYPICAL JUNCTION CAPACITANCE**

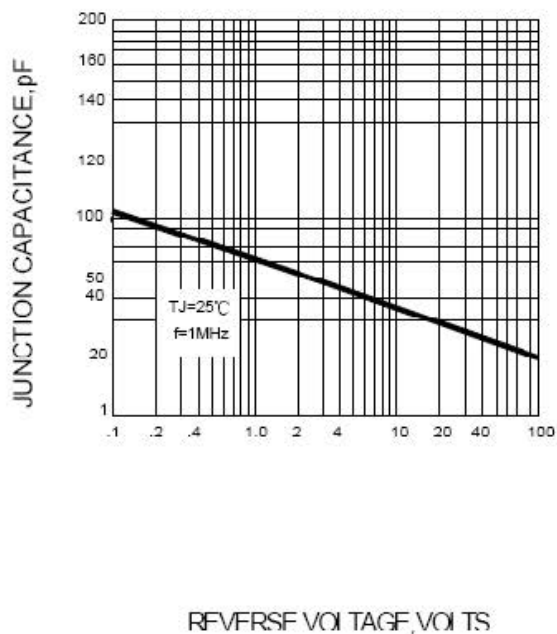

Device	Package	Shipping
KBJ4A--KBJ4M	KBJ4	250 Units/Box